

# Snow-Nabstedt Power Transmissions

## Parts Manual

Effective January 28, 2002 U.S. patent 2,370,484

**Model #  
5101B-19**

### *The Premier Rolling Experience*



Using the greensiron  
***SLIP ELIMINATOR***  
inconjunction with  
the **SNPT**  
**5101B-19** to  
eliminate the drive  
roller slipping on  
your greens

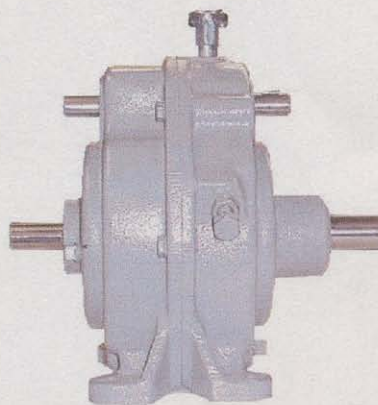

### ***Snow-Nabstedt Power Transmissions***

111 Joliette Street, Manchester, NH 03102, USA

PH: 603-314-0017 FX: 603-668-1438

<http://www.snpt.biz>

e-mail: [sales@snpt.biz](mailto:sales@snpt.biz)

Customer Support Line: 1-603-661-5551

## The Customer Commitment

*As the General Manager for Snow-Nabstedt Power Transmissions I over see all the day to day functions and high quality standards that have made us one of the leading transmission manufacturers. With this responsibility I can give you my personal guarantee to the commitment and pride taken by all the SNPT personnel in the building of every 5000 series product. Every person understands there job and goes the extra mile to insure you, **The Customer**, the highest quality product every time.*

*We believe that every customer is a valued customer. We also understand that at anytime there maybe questions about our products that you will need help on. With time being money, we have a customer support line available that has made us available to answer your questions 24 hours a day, seven days a week, all year long. This service is available to every SNPT transmission user by calling 1-603-661-5551. Just leave a message an one of our dedicated personnel will return your call in a prompt and courteous manner.*

*Remember, that all of us here at Snow-Nabstedt take a great deal of pride in our products. I'm sure that as you use the transmission you just received you will see our commitment to quality and you, **"The Customer"**.*

**Thank you,**

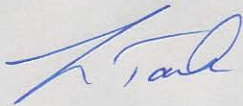

**Lee A. Tack  
General Manager**



# SNPT

## Warranty

**Snow-Nabstedt Power Transmissions** 's guarantees their products to be made of first class material and built in a skillful and workmanlike manner. Every transmission must and does go through a rigorous testing procedure to insure that every transmission is in perfect running order when it leaves the factory. They are guaranteed against any defective material or workmanship. Any part proven defective within twelve months of the shipment will be repaired or replaced free of charge. On the return of such defective parts to **Snow-Nabstedt Power Transmissions**, any transportation charges will be the responsibility of the customer. No parts shall be returned without the express authorization of **Snow-Nabstedt Power Transmissions** before shipment.

There are no warranties, expressed or implied, except such warranties as are definitely set forth within. Any part of, or part manufactured, altered or repaired by non-authorized personnel without the written approval from **Snow-Nabstedt Power Transmissions** shall void all warranties set forth within. Under no circumstances will **Snow-Nabstedt Power Transmissions** be charges for labor to evaluate or install parts to a transmission under warranty unless agreed to in advance by the General Manager or authorized personnel of **Snow-Nabstedt Power Transmissions**. The customer shall pay for shipping charges on warranty parts unless **Snow-Nabstedt Power Transmissions** agrees in advance to pay for the charges.

**Snow-Nabstedt Power Transmissions** shall in no event be held liable for any consequential damages or other delays caused by defective material. Equipment and accessories, including bearings, not manufactured by **Snow-Nabstedt Power Transmissions** are guaranteed only to the extent of the original manufacturer's guarantee.

**Snow-Nabstedt Power Transmissions** reserves the right to improve its products though changes in design or material without being obligated to incorporate such changes in products of prior manufacture.

## Adjustment

Adjustments to the forward or reverse brake band are accomplished externally by moving the screws that project from each side of the transmission. The forward or reverse engaged positions have there own independent adjustment bolt. Always test a new transmissions adjustments before running to insure proper tension and to prolong the life span of the brake bands.

To perform an adjustment, loosen the jam nut to the desired band. Turn the adjustment bolt in a fraction of a turn for more tension and out for less tension. This adjustment should done when the transmission is in the neutral position. Next, test the tension by engaging the operation lever by moving it towards its respective adjustment bolt. Repeat this procedure until the desired tension is accomplished. Never move the adjustment bolt more than a eighth to a quarter of a turn for each adjustment cycle. After attaining the desire tension, tighten the jam nut securely.

Do not over tighten the brake bands excessively, since this will only cause an increase in the shifting force without improving the performance of the transmission and may result in damaged brake bands. Occasionally, during cold weather operation, the brake bands may slip even though they are adjusted correctly. In such cases, the lubricant must be changed to a lighter grade of motor oil. See the lubrication section for further instructions.

# SNPT

## Lubrication

**Important:** All transmissions are shipped dry from SNPT's factory. Be sure to add oil before running.

Quality of oil should be a good grade of SAE30 non-detergent motor oil for operating conditions above 32 degrees F. For operating conditions below 32 degrees F use SAE10 motor oil.

Fill the transmission up to the oil level hole on the front side of the transmission next to the output shaft. Sometimes oil will follow the internal parts and flow out of the oil level hole before the transmission has filled to the proper level. Always be certain the transmission filled to the oil level holes before running.

If the transmission requires a shelf life of more than 60 days, completely fill with SAE 30 non-detergent oil while being stored. If the transmission is not filled before storing make sure to fill the transmission with oil and let stand for 72 hours. In both cases, when ready to use the transmission drain the transmission to its proper oil level. If practical, to insure prolonged life, allow the transmission to run without a load for approximately one hour.

## Oil Changes

After the transmission has run for its first 25 to 30 hours drain and refill it with 1.65 pints of new SAE30 non-detergent motor oil.

Thereafter, a change of oil should be done every 100 to 150 hours of operation or every six months, whichever comes first, for transmissions operating under favorable conditions.

Where operating conditions are severe, such as a rapid rise or fall in temperature where the gear case will develop condensation on the inside walls and result in the formation of sludge. When operation is in a moist or dusty atmosphere, or in the presence of chemical fumes, change the oil at intervals of one to three months.

## Replacing Parts

Should it become necessary to replace parts in your transmission all parts should be ordered from Snow-Nabstedt Power Transmission or an authorized distributor. Many of the parts used in the transmission have extremely close tolerances and require special tooling to assemble. Ordering full assemblies will assist in the proper replacement of parts.

Should it become necessary to replace any of the gears due to excessive wear or breakage, carefully examine the mating gears for wear or cracks. If any doubt exists as to the condition of the mating gear, the mating gear should be replaced at the same time.

Starting a standard maintenance program will extend the life span of your transmission. Every 5 to 7 years bearings need to be replaced and oil seal need replacement every 4 to 5 years. Whenever the transmissions opened, replace the used gasket with a new one when reassembling.

### Snow-Nabstedt Power Transmissions

111 Joliette Street, Manchester, NH 03102 USA

PH: 603-314-0017 FX: 603-668-1438 e-mail: sales@snpt.biz

# Snow-Nabstedt Power Transmissions

## \*\*Installation Drawing\*\*

Maximum Horsepower	10
Maximum Operating Speed	3600 R.P.M.
Maximum Torque(Output)	500(In. Lbs.)
Reduction Ratio Forward	2.47:1
Reduction Ratio Reverse	2.47:1
Oil Capacity	1.65 Pints
Side Load Capacity	400(Ft. Lbs.)
Lubrication	SAE30

- \*\*This unit may be reverse frequently and under a load at any speed
- \*\*Never install using the output shaft as the input .
- \*\*Always add oil before running as the transmissions are shipped dry.
- \*\*Control Levers are optional equipment and sold separately.
- \*\* Any questions be sure to consult the factory

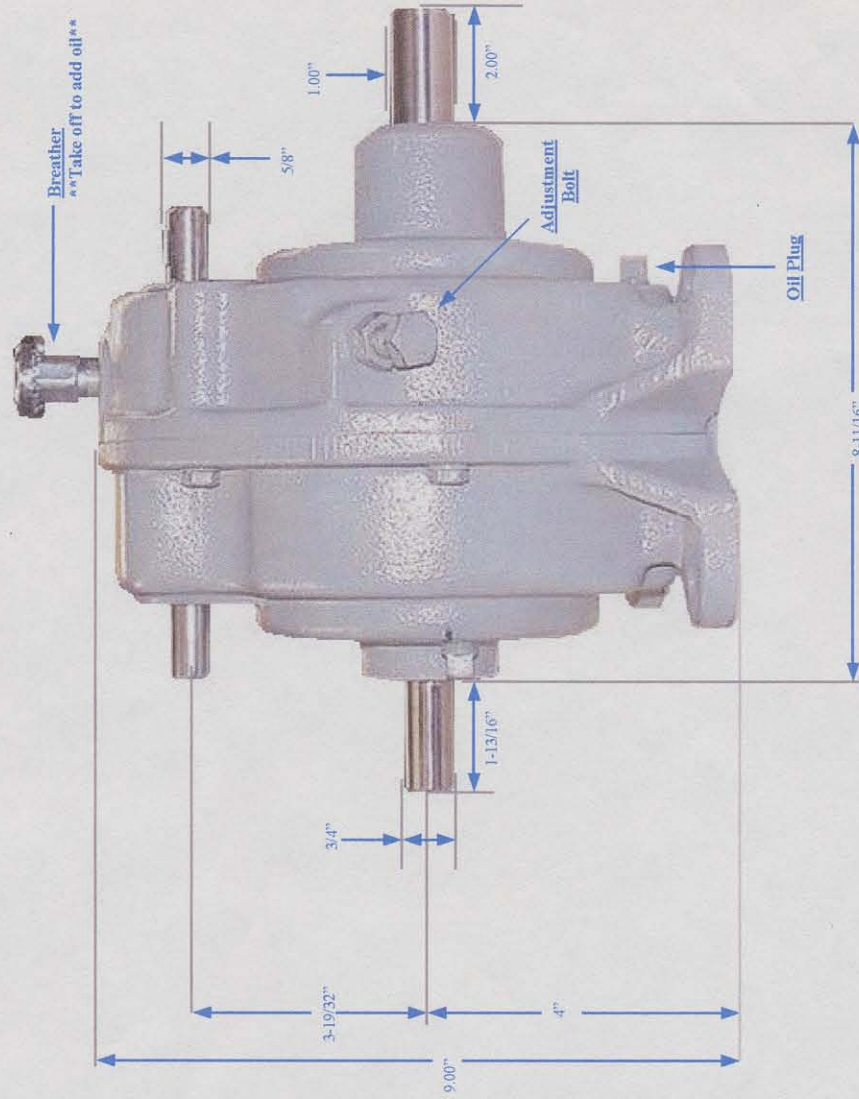

Snow-Nabstedt Power Transmissions  
 111 Joliette Street, Manchester, NH 03102 USA  
 PH: 603-314-0017 FX: 603-668-1438  
<http://www.snpt.biz> e-mail: sales@snpt.biz

# Snow-Nabstedt Power Transmissions

\*\*5101B-19 Parts Break Down\*\*

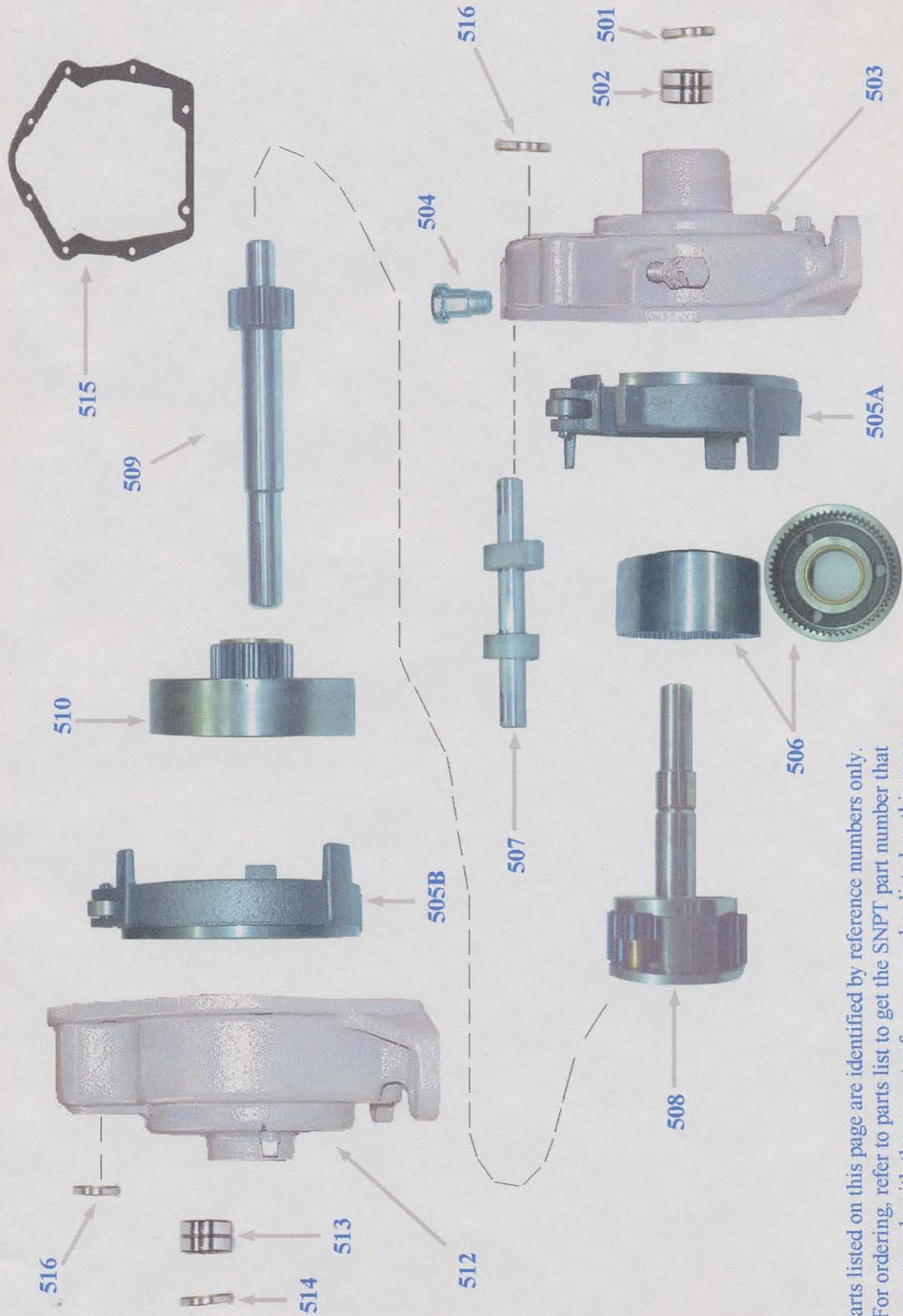

**\*\*Note:** Parts listed on this page are identified by reference numbers only. For ordering, refer to parts list to get the SNPT part number that corresponds with the correct reference number listed on this page.

# Snow-Nabstedt Power Transmissions

**\*\*5101B-19 Parts List\*\***

<u>Item #</u>	<u>Part Number</u>	<u>Description</u>	<u>Quantity</u>
501	20186	Oil Seal	1
502	10237-1	Bearing	1
503	30X-5106	Output Housing Assembly	1
503A	6267	Bushing	1
503B	4527	Adjustment Bolt	1
503C	1703	Jam Nut	1
504D	2101	Pipe Plug	2
504	30H-5105	Breather	1
505	5X-5104	Brake Band Assembly	2
506	7AX-5106	Gear Drum Assembly	1
507	27AX-51017	Cross Shaft Assembly	1
507A	(10)-5104	Cam	2
507B	27A-51017	Cross Shaft	1
508	3X-5104	Gear Cage Assembly	1
508A	48X-5106	Output Shaft Assembly	1
508B	(3)-5104	Gear Cover	1
508C	9AX-5103	Short Pinion Assembly	2
508D	9X-5103	Long Pinion Assembly	2
508E	6271	Bushing	2
508G	6273	Bushing	1
509	26-5109	Input Shaft	1
510	8AX-5102	Flat Drum Assembly	1
510A	8X-5102	Gear Assembly	1
510B	26A-5101	Bushing	1
510C	6272	Bushing	1
510D	50142	Snap Ring	1
512	30X-51027	Input Housing Assembly	1
512A	4527	Adjustment Bolt	1
512B	1703	Jam Nut	1
513	10736	Bearing	1
514	2076	Oil Seal	1
515	31A-5105	Gasket	1
516	20187	Oil Seal	2
520	1234	Key	1
521	8TR-5101	Washer	1
522	8TF-5101	Washer	1
523	8TR-5134	Washer	1

## Quick Purchase Standard Maintenance Kits

### Part Number = Description

**BB101** - (2) Brake Bands, (4) Oil seals, and a Gasket

**BEAR101** - All Bearings and a Gasket

**SEL101** - All oil seals, gasket, and a breather

**15101** - 1.65 Pints SAE30 non-detergent motor oil

**\*\*Note:** Parts are stocked as assemblies. So, if the item you are looking for has already been assembled the full assembly will need to be ordered.

If the part needed is not on the parts list it can be ordered as part of an assembly.

## Snow-Nabstedt Power Transmissions

111 Joliette Street, Manchester, NH 03102 USA

PH: 603-314-0017 FX: 603-668-1438

http://www.snpt.biz email: sales@snpt.biz